



## SPARE PART LIST

Spare Part ItemCode	Item name.	PictureId
6260.00002.05	ADJUSTABLE LEG M6	14
9099.00A60.00	GAS VALVE MAX-MIN ADJUSTMENT PILOT OUTPUT WITH THERMOCOUPLE SAFE 21S	18
6260.00015.46	THERMOPLASTIC KNOB MAIN BODY WITH 8 mm INSERT	19
6267.00020.33	PILOT BURNER ASSEMBLY LONG FOR 900 SERIES COOKERS	2
6260.00015.40	THERMOPLASTIC KNOB SCALE MAX.-MIN FLAME-LIGHTING	20
2KLP.460.626700006.05	MAIN BURNER NOZZLE M8x0,75 ANY GAS TYPE	25
6267.00002.046	BURNER ASSEMBLY 10 Kw FOR 900 SERIES GAS COOKERS	27
6267.00024.00	THERMOCOUPLE 9/1 600 mm LENGTH	3
6267.00002.048	BURNER ASSEMBLY 6 Kw FOR 900 SERIES GAS COOKERS	34
2179.09028.01	LABEL FOR FRONT PANEL "ÖZT RYAK LER"	35
2865.N20.04000290.G.10	FRONT PANEL FOR 40'S GAS COOKER	36
6267.00020.51	PILOT ASSEMBLY SHORT	37
6260.00058.43	PAN SUPPORT CAST IRON W CERAMIC ENAMEL COATED FOR 900 SERIES COOKERS	4



DİKKAT: BU DÖKÜMANIN COĞALTILMASI İNTERNET ORTAMINDA DOLAŞTIRILMASI VE BU ÇİZİMLER DOĞRULUĞUNDA ÜRETİMİN YAPILMASI ÖZTİRYAKLER FİRMASININ ONAYI İLE OLABİLİR. TÜM HAKLARIMIZ SAKLIDIR.

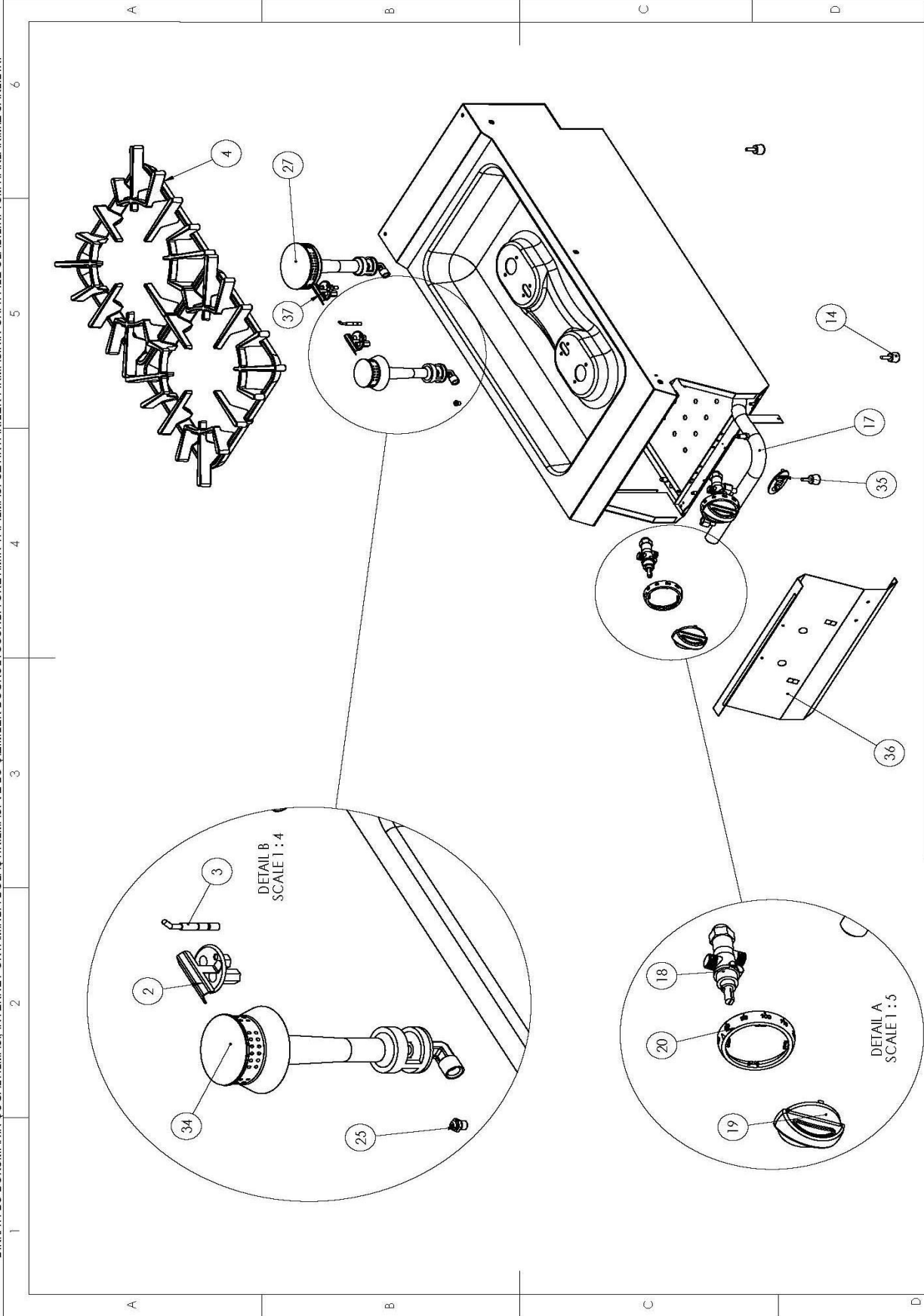

## Öztiyıklar

PARÇA ADI  
gazlı ikili ocak

RİSD	BİM	İMCA	TARİH	MATERİAL	TOLERANS
ÇİZEN	E.BAŞTUĞ		22.12.2012		DIN 71 68
KONTROL	M.HACI		22.12.2012		ORTA
ONAY	M.HACI		22.12.2012		
REVİZYON	REVİZYON	1	ÖLÇEK	1:50	T.RESİM NO
AGIRLIK(GR.)	33 101,48	KALINLIK			OSOG 4090 patlamış

## ARGE KONTROLLÜ KOPYA

V13.01

RESİM ÜZERİNDEN ÖLÇÜ ALMAYINIZ! TÜM ÖLÇÜLER mm ÇİNSİNDİR

WARNING: IT IS APPROPRIATE TO MULTIPLY, USE, DISPLAY AT COMPUTER/INTERNET AND PRODUCE THE PRODUCT WITH ITS DRAWINGS WITH THE APPROVAL OF ÖZTİRYAKLER COMPANY. ALL RIGHTS RESERVED.